

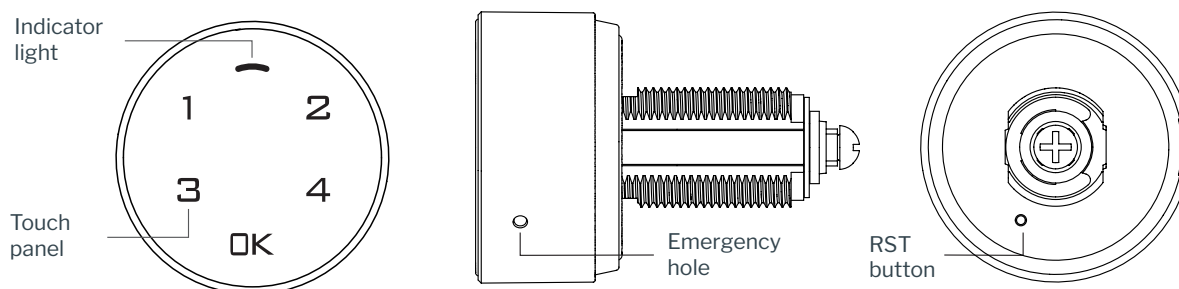

Keyfree 200

Keypad Lock Instructions



1. Operation

Unlocking

1. Input the factory default password "1234" followed by "OK".
2. The buzzer will emit a long "di" sound, and the green indicator light will turn on.
3. Rotate the knob within 3 seconds to open the lock.

Locking

1. Rotate the knob back to the lock position.
2. The red indicator light will flash.

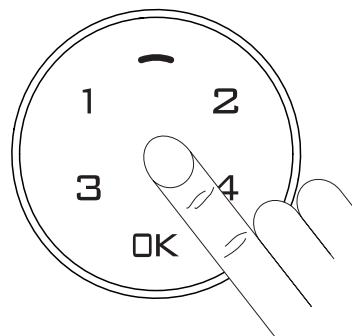

2. Settings

Changing Password

Input the current user password or management password followed by "OK".

The buzzer will emit a long "di" sound, and the indicator light will turn on.

Press "OK" for at least 2 seconds until the indicator light flashes.

Input the new password and press "OK". A long "di" sound indicates the password has been changed.

Note

Passwords can be 4-15 digits long. The management password cannot be the same as the user password.

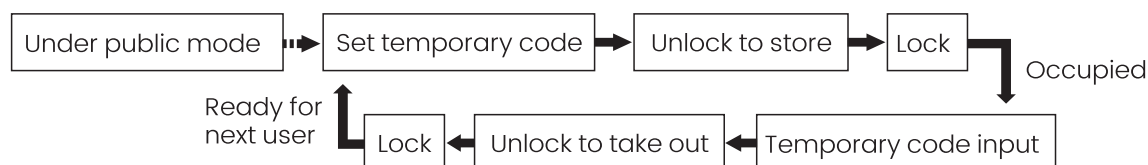

Turning on Public Mode

1. Input the current management password followed by "OK". The buzzer will emit a long "di" sound, and the indicator light will turn on.
2. Press "OK" for at least 2 seconds until the indicator light twinkles, then press "OK" again.
3. Input "4 4" and press "OK". A long "di" sound indicates public mode is active.

Setting Temporary Password

Press "OK". The indicator light will twinkle.

1. Input the new password consisted of 4 - 15 digits
2. Press OK, hear a long di, unlocking indicator light is on, temporary password already been set.

Note

The temporary password can only be used once.

Turning off Public Mode

4. Input the current management password followed by "OK". The buzzer will emit a long "di" sound, and the indicator light will turn on.
5. Press "OK" for at least 2 seconds until the indicator light twinkles, then press "OK" again.
6. Input "4 3" and press "OK". A long "di" sound indicates public mode is turned off.

Turning On/Off Fake PIN Code Function

7. Input the current management password followed by "OK". The buzzer will emit a long "di" sound, and the indicator light will turn on.
8. Press "OK" for at least 2 seconds until the indicator light twinkles, then press "OK" again.
9. To turn on, input "4 2" and press "OK". A long "di" sound confirms activation.
10. To turn off, input "4 1" and press "OK". A long "di" sound confirms deactivation.

Note

With Fake PIN code function, you can input any code(s) before or after the real password to prevent it from being peeped (maximum 16 digits).

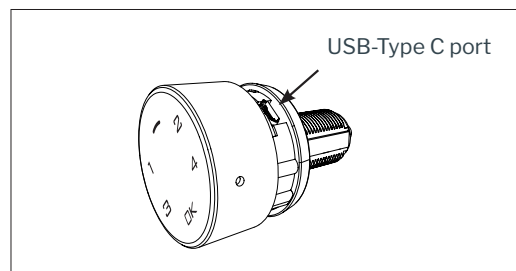
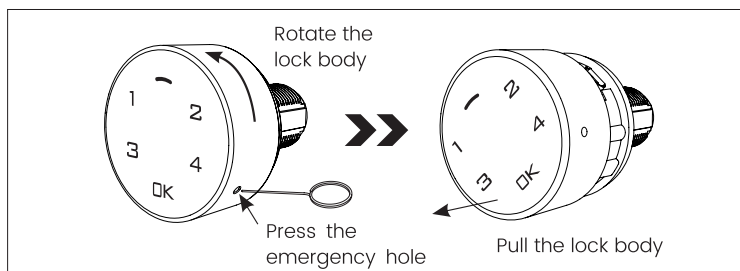

3. Decoding and Prompts

Decoding

If the password is forgotten, you can provide the code on the lock body to the distributor for decoding. This will reset the password to the original management password “4321” and user password “1234”.

Auto-alarm

The auto-alarm will activate after 4 incorrect password attempts, and the lock will be deactivated for 60 seconds.

Power Shortage Prompt

A red signal will indicate low voltage. The lock cannot be operated when the voltage is very low.

4. Battery Replacement

The Qi-400K uses a CR2450 battery. The last password will not be lost after changing the battery.

5. Troubleshooting

Problem: Red signal twinkles when inputting the password.

Cause: Low voltage.

Solution: Replace batteries.

Problem: Alarm sounds when inputting the password, and the lock cannot be opened.

Cause: Knob is not in the right position.

Solution: Turn the knob to the correct position.

Problem: Touch button makes no sound, but the lock can be opened.

Cause: Buzzer is broken.

Solution: Replace the buzzer.

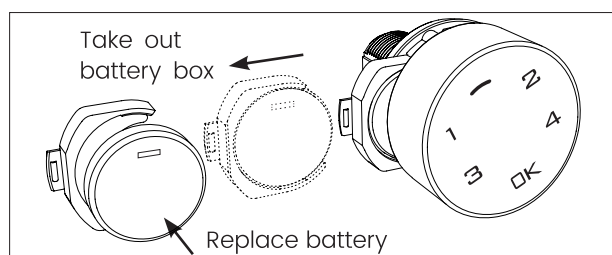

6. Fixing Hole and Installation

